

I/SIR/KZ-10

TELAIO SIRIUS MOD. KZ 106/CH/14
SIRIUS CHASSIS MOD. KZ 106/CH/14

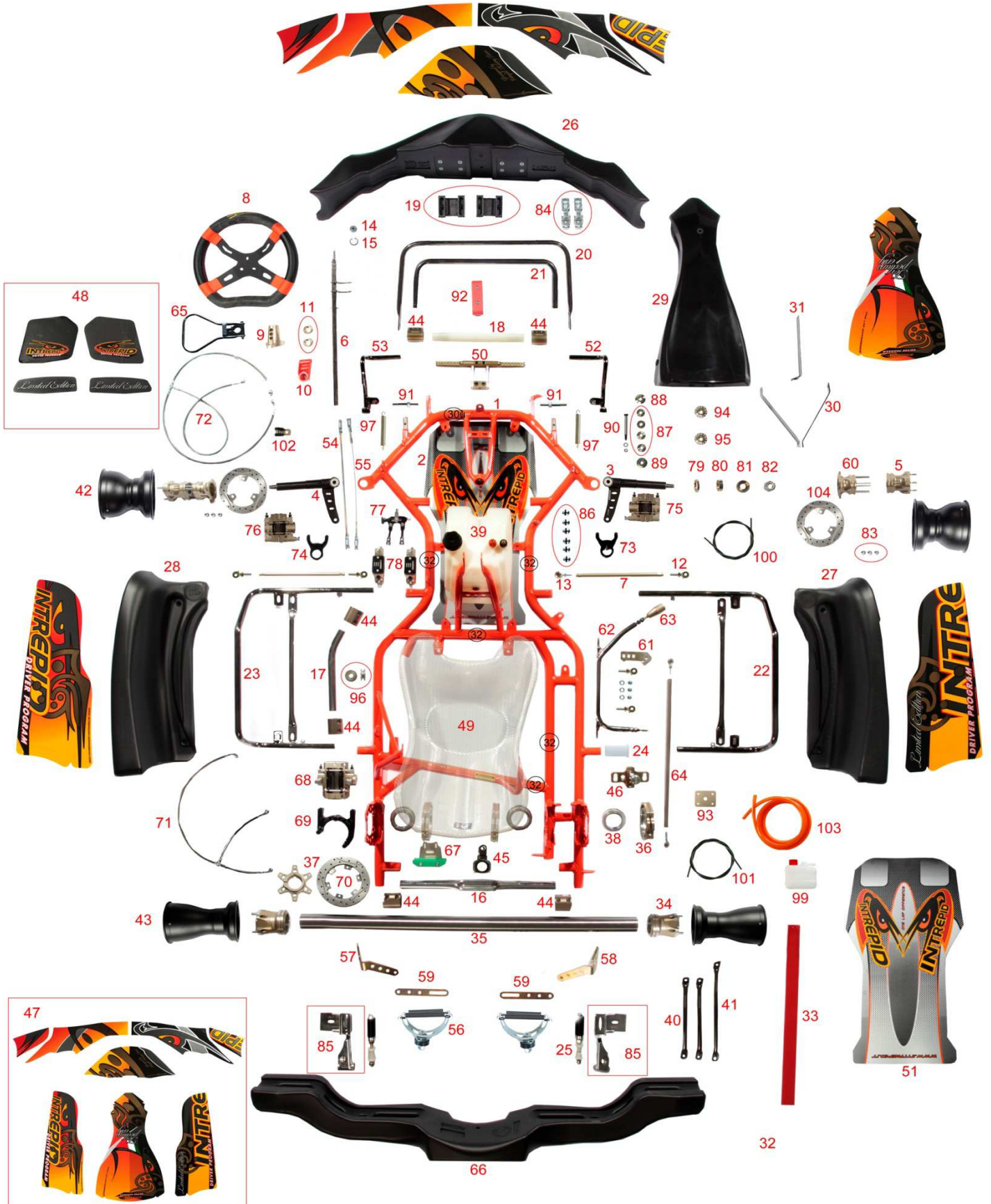

Pos. Codice / Code	Descrizione / Description
1 I/SIR-10	SCocca SIRIUS Ø32mm <i>SIRIUS FRAME Ø32mm</i>
2 I/INT0694-06	PIANALE MOD. RACING <i>RACING FLOOR PLATE</i>
3 I/INT1161SHND X-09	FUSELLO DX Ø25mm H1 - CARBON CHROME <i>RIGHT SPINDLE Ø25mm H1 - CARBON CHROME</i>
4 I/INT1161SHNSX-09	FUSELLO SX Ø25mm H1 - CARBON CHROME <i>LEFT SPINDLE Ø25mm H1 - CARBON CHROME</i>
5 I/INT1064L75-08	MOZZO ANTERIORE L.75mm - TITAN-GOLD <i>FRONT HUBS L.75mm - TITAN-GOLD</i>
6 I/INT1039-08	PIANTONE STERZO L.490mm CARBON CHROME <i>STEERING COLUMN L.490mm CARBON CHROME</i>
7 I/INT0983-07	BARRETTA STERZO L.270mm TITAN-GOLD <i>TIE ROD L.270mm TITAN GOLD</i>
8 I/INT0144-05	VOLANTE 4 RAZZE Ø330mm <i>STEERING WHEEL WITH 4 SPOKES Ø330mm</i>
9 I/ST053TG-08	MOZZO VOLANTE INCLINATO - 3 FORI - TITAN-GOLD <i>INCLINED STEERING WHEEL HUB - 3 HOLES - TITAN GOLD</i>
10 I/ST079RS-05	SUPPORTO PER PIANTONE STERZO - NYLON - 2FORI - ROSSO <i>STEERING COLUMN SUPPORT - NYLON - 2 HOLES - RED</i>
11 I/ST001TG-08	ANELLO DI FERMO PIANTONE TITAN-GOLD <i>STEERING LOCKING COLUMN BUSH TITAN GOLD</i>
12 I/ST110DX-05	UNIBALL M8 DX - AC <i>RIGHT UNIBALL M8 - AC</i>
13 I/ST110SX-05	UNIBALL M8 - SX - AC <i>LEFT UNIBALL M8 - AC</i>
14 I/ST046-05	UNIBALL PIANTONE STERZO PB8 <i>UNIBALL FOR STEERING COLUMN PB8</i>
15 I/ST051-05	SEEGER Ø22mm PER UNIBALL PIANTONE STERZO <i>SNAP RING Ø22mm FOR STEERING COLUMN UNIBALL</i>
16 I/INT0014-05	BARRA STABILIZZATRICE Ø28mm POST. <i>REAR STABILIZER ROD Ø28mm</i>
17 I/INT1074-08	BARRA STABILIZZATRICE Ø28mm LAT. <i>LATERAL STABILIZER ROD Ø28mm</i>
18 I/INT0970-07	BARRA STABILIZZATRICE Ø28mm ANT. - NYLON <i>NYLON FRONT STABILIZER ROD Ø28mm</i>
19 I/INT0821-06	KIT PLACCA FISSAGGIO SPOILER ANT. FP7/CIK17 <i>FASTENING KIT FOR FRONT SPOILER MOD. FP7/CIK17</i>
20 I/INT0840-06	PARAURTI ANT. SUPERIORE MOD. FP7/CIK17 <i>HIGHER FRONT BUMPER MOD. FP7/CIK17</i>
21 I/INT0841-06	PARAURTI ANT. INFERIORE MOD. FP7/CIK17 <i>LOWER FRONT BUMPER MOD. FP7/CIK17</i>
22 I/AR760DX-09	SUPPORTO CARENATURA LAT. DX MOD. STILO CIK/14 <i>RIGHT SUPPORT FOR BODYWORK MOD. STILO CIK/14</i>
23 I/AR760SX-09	SUPPORTO CARENATURA LAT. SX MOD. STILO CIK/14 <i>LEFT SUPPORT FOR BODYWORK MOD. STILO CIK/14</i>
24 I/INT0662-06	BOCCOLA IN TEFLON PER ATTACCO PARAURTI LATERALE <i>FASTENING WASHER IN TEFLON FOR LATERAL BUMPER</i>
25 I/INT0677TG-08	KIT ATTACCO PARAURTI POST. Ø30mm BOCCOLE - TITAN-GOLD <i>REAR BUMPER FASTENING KIT Ø30- TEFLON WASHERS TITAN-GOLD</i>
26 I/AR750NR-09	SPOILER ANTERIORE MOD. FP7/CIK17 <i>FRONT SPOILER MOD. FP7/CIK17</i>
27 I/AR759NRDX-09	CARENATURA LATERALE DX MOD. STILO CIK/14 <i>RIGHT BODYWORK MOD. STILO CIK/14</i>
28 I/AR759NRSX-09	CARENATURA LATERALE SX STILO CIK/14 <i>LEFT BODYWORK MOD. STILO CIK/14</i>
29 I/AR752NR-09	FRONTALINO PORTANUMERO MOD. FP7/CIK17 <i>FIXING KIT FOR LATER BODYWORK MOD. STILO CIK/14</i>
30 I/INT0819-06	COPPIA SUPPORTO SUP. FRONTALINO <i>UPPER COUPLE FOR NUMBER PLATE HOLDER</i>

31	I/INT1009-07	SUPPORTO INFERIORE FRONTALINO <i>LOW SUPPORT FOR NUMBER PLATE HOLDER</i>
32	I/AR086-05	STAFFA SUPPORTO PARACATENA KZ <i>SUPPORT CLAMP FOR CARTER CHAIN GUARD</i>
33	I/AR085-05	PARACATENA PER KZ <i>CHAIN GUARD FOR KZ</i>
34	I/INT1034L95-08	MOZZO POST. ALLUMINIO Ø50X95mm TITAN-GOLD <i>REAR HUB Ø50X95mm TITAN-GOLD</i>
35	I/INT2-30	ASSALE Ø50 - 1030mm MOD. T2 - UNIVERSALE <i>UNIVERSAL AXLE Ø50 - 1030mm MOD. T2</i>
36	I/INT1035-08	GUSCIO PORTACUSCINETTO Ø50mm TITAN-GOLD <i>BEARING BUSH SUPPORT Ø50mm TITAN-GOLD</i>
37	I/INT1037-08	PORTADISCO Ø50mm TITAN-GOLD <i>DISK SUPPORT Ø50mm TITAN-GOLD</i>
38	I/CU017-08	CUSCINETTO PER ASSALE Ø50X80mm / 3 GRANI <i>AXLE'S BEARING Ø50X80mm / 3 PINS</i>
39	I/AR277-05	SERBATOIO "ANTISBATTIMENTO" 8,5L. MOD. KG <i>"ANTISHAKING" TANK 8,5L. MOD. KG</i>
40	I/AR755-09	RINFORZO SEDILE TONDO L.320mm - CROMATO <i>CHROMED ROUND SEAT SUPPORT L.320mm</i>
41	I/AR756-09	RINFORZO SEDILE TONDO L.340mm - CROMATO <i>CHROMED ROUND SEAT SUPPORT L.340mm</i>
42	I/CE104MG-10	CERCHIO ANTERIORE Ø132mm MOD. DOUGLAS - NERO <i>FRONT RIM Ø132mm MOD. DOUGLAS - BLACK</i>
43	I/CE103MG-10	CERCHIO POSTERIORE Ø212mm MOD. DOUGLAS - NERO <i>REAR RIM Ø212mm MOD. DOUGLAS - BLACK</i>
44	I/AR197ALTG-08	FASCETTA STRINGITUBO Ø28mm - AL - TITAN-GOLD <i>TIGHTENING PIPE BELT Ø28mm - AL - TITAN-GOLD</i>
45	I/GT017TG-05	SUPPORTO Ø30MM PER POMPA ACQUA - TITAN-GOLD <i>Ø30mm WATER PUMP SUPPORT - TITAN-GOLD</i>
46	I/INT1094-08	SPINGIMOTORE COMPLETO <i>CHAIN STRETCHER</i>
47	I/INT1129-08	KIT ADESIVI CARENATURE <i>COMPLETE STICKERS KIT</i>
48	I/INT1130-08	KIT ADESIVI SERBATOIO <i>STICKERS KIT FOR FUEL TANK</i>
49	I/INT0896-06	SEDILE MOD. RACING SILVER <i>SEAT MOD. RACING SILVER</i>
50	I/INT0992-07	SISTEMA POGGIPIEDI REGISTRABILE <i>ADJUSTABLE FOOTREST SYSTEM</i>
51	I/INT0971-07	ADESIVO INTREPID PER PIANALE <i>STICKER FOR FLOOR PLATE</i>
52	I/INT0967-07	PEDALE ACCELERATORE - CROMATO <i>CHROMED ACCELERATOR PEDAL</i>
53	I/INT0968-07	PEDALE FRENO - CROMATO <i>CHROMED BRAKE PEDAL</i>
54	I/FR354-05	KIT COMPLETO TIRANTE FRENO - M6X410 <i>CHROMED TIE ROD - M6X410</i>
55	I/FR105-05	CAVO DI SICUREZZA L.350mm <i>SAFETY STEEL CABLE L.350mm</i>
56	I/AR181-05	CULLA MARMITTA COMPLETA DI MOLLE <i>COMPLETE SILENCER HOLDER</i>
57	I/INT1118-08	SUPPORTO CULLA MARMITTA SX - TRATTAMENTO GIALLO <i>LEFT SILENCER HOLDER - YELLOW TRATMENT</i>
58	I/INT1119-08	SUPPORTO CULLA MARMITTA DX - TRATTAMENTO GIALLO <i>RIGHT SILENCER HOLDER - BLACK YELLOW TRATMENT</i>
59	I/INT1120-08	STAFFA PER SUPPORTO CULLA MARMITTA - TRATTAMENTO GIALLO <i>SUPPORT BRACKET FOR SILENCER HOLDER - YELLOW TRATMENT</i>
60	I/INT1065-08	PORTA DISCO ANTERIORE KZ - R2 TITAN-GOLD <i>FRONT DISC SUPPORT KZ - R2 TITAN-GOLD</i>
61	I/INT0713-06	ADATTATORE LEVA CAMBIO <i>GEAR LEVER ADAPTER</i>

62	I/INT0994-07	LEVA CAMBIO CROMATA <i>CHROMIUM PLATED GEAR LEVER</i>
63	I/INT0993TG-09	POMELLO LEVA CAMBIO ANOD. TITAN-GOLD <i>GEAR LEVER HANDLE - TITANIUM</i>
64	I/AR101TG-08	ASTA CAMBIO ESAGONALE L.495mm - TITAN-GOLD <i>HEXAGONAL L 495mm GEAR ROD AL - TITAN-GOLD</i>
65	I/AR099-05	LEVA FRIZIONE E SUPPORTO - CROMATA <i>CLUCHT LEVER AND SUPPORT - CHROMIUM PLATED</i>
66	I/AR608-06	PARAURTI POSTERIORE IN PLASTICA MOD. KG CON KIT ATT. <i>PLASTIC REAR BUMPER MOD. KG WITH SUPPORT KIT</i>
67	I/INT1135-09	PROTEZIONE DISCO FRENO POSTERIORE <i>REAR BRAKE DISK PROTECTOR KIT</i>
68	I/INT1052-08	PINZA FRENO POSTERIORE R1/R2/FRM.R1 109/108/185/FR/14 <i>REAR BRAKE CALIPER R1/R2/FRM.R1 109/108/185/FR/14</i>
69	I/INT1063-08	SUPPORTO PINZA POSTERIORE R1/R2 - AL - NERO <i>REAR BRAKE CALIPER SUPPORT R1/R2 - AL - BLACK</i>
70	I/INT1054-08	DISCO FRENO POSTERIORE R1/R2 <i>REAR BRAKE DISC R1/R2</i>
71	I/INT1051-08	KIT TUBO FRENO POSTERIORE R1/R2 <i>REAR BRAKE TUBE R1/R2</i>
72	I/INT1061-08	KIT TUBO FRENO ANTERIORE R2 <i>FRONT BRAKE TUBE R2</i>
73	I/INT1073DX-08	SUPPORTO PINZA ANT. DX R2 - NERO <i>FRONT CALIPER PLATE SUPPORT R2 - RIGHT - BLACK</i>
74	I/INT1037SX-08	SUPPORTO PINZA ANT. SX R2 - NERO <i>FRONT CALIPER PLATE SUPPORT R2 - LEFT - BLACK</i>
75	I/INT1057DX-08	PINZA FRENO ANT. DX R2 108/FR/14 <i>FRONT BRAKE CALIPER R2 - RIGHT - 108/FR/14</i>
76	I/INT1057SX-08	PINZA FRENO ANT. SX R2 108/FR/14 <i>FRONT BRAKE CALIPER R2 - LEFT - 108/FR/14</i>
77	I/FR046-05	RIPARTITORE DI FRENATA IN ERGAL - LEVE FISSE <i>ERGAL BRAKING DISTRIBUTION - FIXED LEVERS</i>
78	I/INT0103-05	POMPA FRENO Ø19mm R1/R2 <i>BRAKE PUMP Ø19mm R1/R2</i>
79	I/FS036-06	SPESSORE FUSELLO Ø25X5mm - GIALLO <i>SPINDLE LINING Ø25X5mm - YELLOW</i>
80	I/FS037-06	SPESSORE FUSELLO Ø25X10mm - GIALLO <i>SPINDLE LINING Ø25X10mm - YELLOW</i>
81	I/FS038-06	RONDELLA Ø25mm PER CHIUSURA MOZZO <i>STEEL WASHER Ø25mm FOR HUB LOCKING</i>
82	I/FS008-05	DADO M14X1,5mm AUTOBLOCCANTE <i>SELFLOCKING NUT M14X1,5mm</i>
83	I/INT1092-08	KIT BOCCOLE FLOTTANTI PORTADISCO ANT. R2 <i>FLOATING BUSH KIT FOR FRONT DISC SUPPORT R2</i>
84	I/INT2013-01	KIT GANCI ATTACCO SPOILER ANTERIORE 2 PZ. <i>CLAMP KIT FOR FRONT SPOILER 2 PZ.</i>
85	I/INT2013-02	KIT SUPPORTO PARAURTI POST. 2 PZ. <i>SUPPORT KIT FOR REAR BUMPER 2 PZ.</i>
86	I/INT2013-03	KIT VITI CON GOMMINO PER FISSAGGIO PIANALE 6 PZ. <i>SCREW KIT WITH RUBBER WASHER FOR FLOOR PLATE 6 PZ.</i>
87	I/INT0734-06	RONDELLA PER REGOLAZIONE FUSELLO Ø10 <i>HIGH REGULATION SPINDLE WASHER Ø10</i>
88	I/INT0956-07	BOCCOLA DRITTA SUPERIORE <i>UPPER STRAIGHT BUSH</i>
89	I/INT0957-07	BOCCOLA DRITTA INFERIORE <i>LOWER STRAIGHT BUSH</i>
90	I/INT0794-06	VITE FUSELLO Ø10 <i>SPINDEL SCREW Ø10</i>
91	I/INT2013-04	VITE ATTACCO PEDALE <i>PEDAL'S SREW</i>
92	I/INT2013-05	COPPIA FISSAGGIO PARAURTI ANT. - PLASTICA - ROSSA 6 PZ. <i>COUPLE OF JOINTS FOR FRONT SPOILER - PLASTIC - RED 6 PZ.</i>
93	I/INT2013-07	PIASTRINA ATTACCO SEDILE - ALLUMINIO <i>SEAT'S PLATE CONNECTION - ALUMINIUM</i>
94	I/INT1010-07	BOCCOLA ECCENTRICA SUPERIORE 1° - GIALLA <i>UPPER HEAD ECCENTRIC BUSH 1° - YELLOW</i>

95	I/INT1011-07	BOCCOLA ECCENTRICA INFERIORE 1° - GIALLA <i>LOWER HEAD ECCENTRIC BUSH 1° - YELLOW</i>
96	I/AR216TG-05	SPESSORE SEDILE Ø30XØ10X10mm - TITAN GOLD <i>SEAT LINING Ø30XØ10X10mm - TITAN GOLD</i>
97	I/AR093-05	MOLLA PEDALE ZINCATA <i>PEDAL SPRING - GALVANIZED</i>
98	I/INT2013-08	SPESSORE UNIBALL PIANOTONE STERZO <i>UNIBALL LINING FOR STEERING WHEEL</i>
99	I/INT2013-09	SERBATOIO DI RECUPERO <i>RECOVER TANK</i>
100	I/AR140NR-05	GUAINA PER CAVO ACCELERATORE - COL. NERO <i>ACCELERATORE SHEATH WIRE - BLACK</i>
101	I/AR141NR-05	GUAINA PER CAVO FRENO/FRIZIONE - COL. NERO <i>SHEATH BRAKE/CLUTCH WIRW - COL. BLACK</i>
102	I/FR097-05	FASCETTA FISSAGGIO TUBO FRENO - Ø8mm <i>BRAKE PIPE FIXING BELT - Ø8mm</i>
103	I/AR078-05	TUBO BENZINA Ø5X10mm - MT. 1 <i>FUEL PIPE - Ø6X9mm - EACH METER</i>
104	I/INT1062-08	DISCO FRENO ANTERIORE R2 <i>FRONT BRAKE DISC R2</i>